

Foreman's Office Assembly Instructions

This kit is a freelance model of a small brick built office suitable for a goods yard or line-side siding. Its "mock tudor" timber framing and brick infill is designed to match the Southwold Railway's architecture.



Most of this kit is laser cut birch plywood. This is moderately water resistant but with a reasonably amount of painting or varnishing should prove rain resistant if not left outside all winter. We do however recommend using water proof PVA wood working glue (e.g. Evostick in the blue bottles) to glue the plywood parts together.

The roof overlays are vacuum formed HIPS. This is easily stuck with various glues and we suggest that epoxy resin (e.g. araldite) is used to stick them to the plywood roof panels.

We have found that spraying the brick work with red car primer paint from an aerosol can, to be a quick way of applying a base brick colour.

Step 1 – Chimney

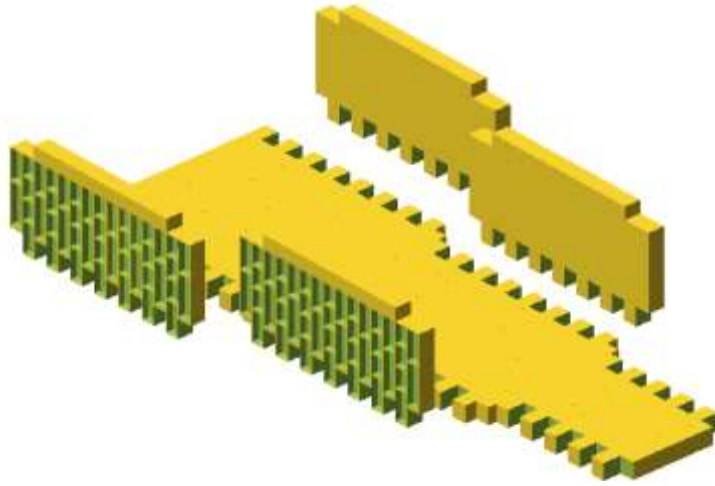

Glue the four chimney stack sides to the chimney/fireplace back. You may find the “teeth” a tight fit in which case lightly file the teeth sides. You do not want to have to force the teeth together as you glue them.

Now glue the remaining chimney top pieces in place together with the two transverse pieces that help form the steps in the chimney stack.

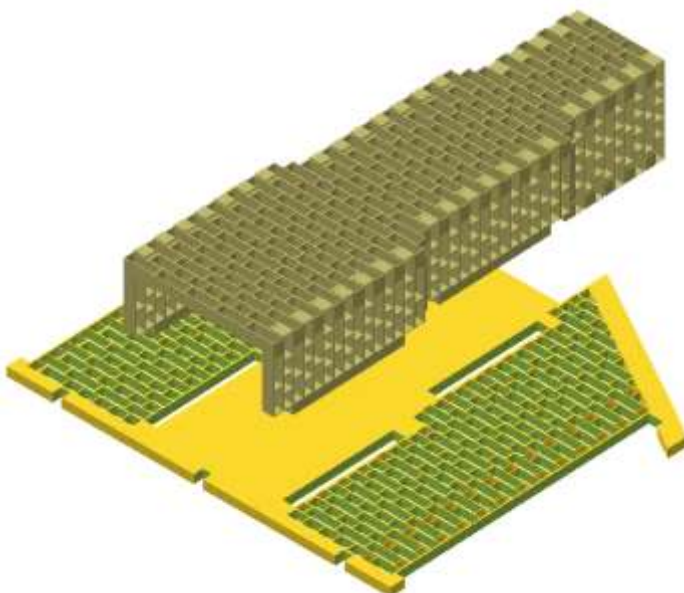
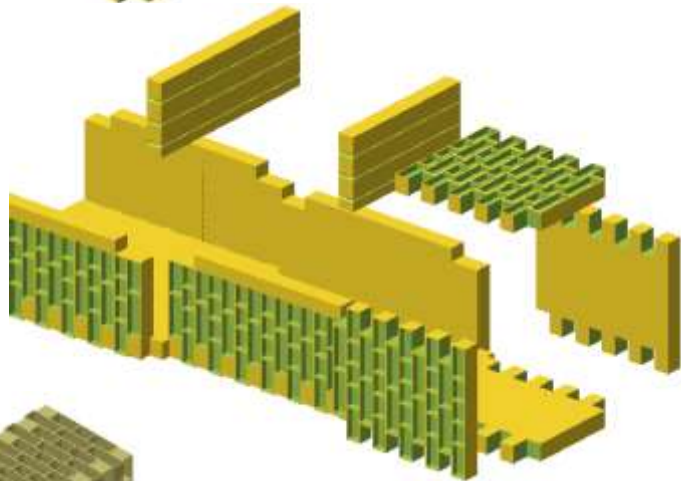

Glue the chimney stack into its locating sockets in the end wall. Ensure all is square and set aside to dry

Once the glue has set, gently file back any corner teeth that are slightly proud. (We have to cut the teeth slight long to allow for variations in the plywood’s thickness.)

Step 2 – Long walls

Glue the back overlay (1.5 mm ply) onto the back wall (3 mm ply). The top and bottom edges should be flush. Make sure the rafter slots align at the top of the wall. Clean off any glue that oozes onto the front face or onto the side edges. Place something flat and heavy on top of the assembly and wait for the glue to set

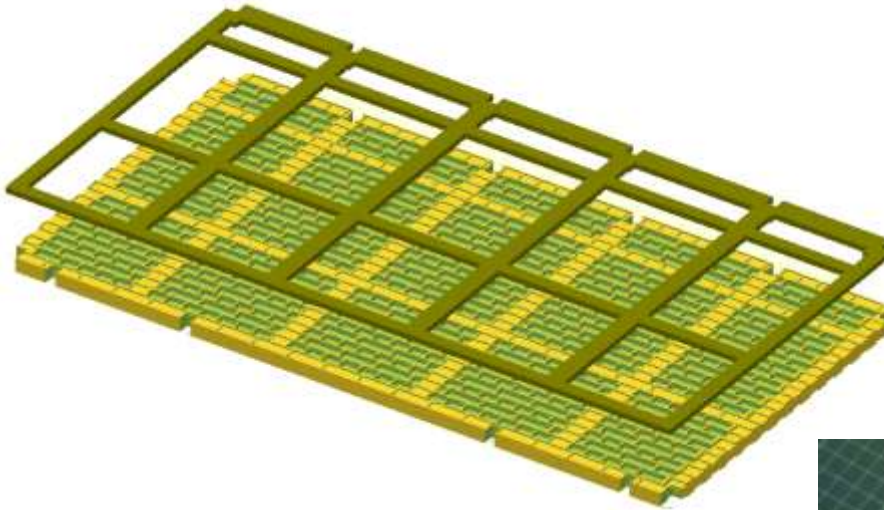

TIP: Temporarily push a couple of scraps of 3 mm ply into the slots to help align the parts.

Repeat for the front wall

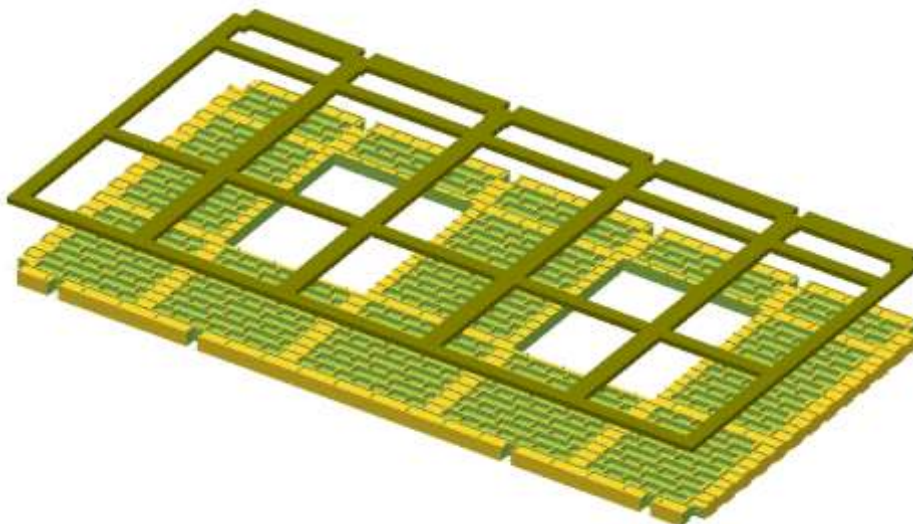
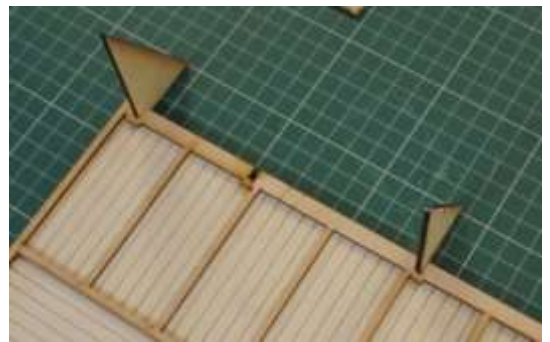

Step 3 – Main Structure

Glue the four walls together on a flat surface. The two “U” shape end brackets help to keep the structure square while the glue sets. Note one bracket includes the door step so ensure it is aligned as shown. Use a couple of very large rubber bands , modellers clamps or picture frame clamps to keep all the joints “tight” while the glue sets.

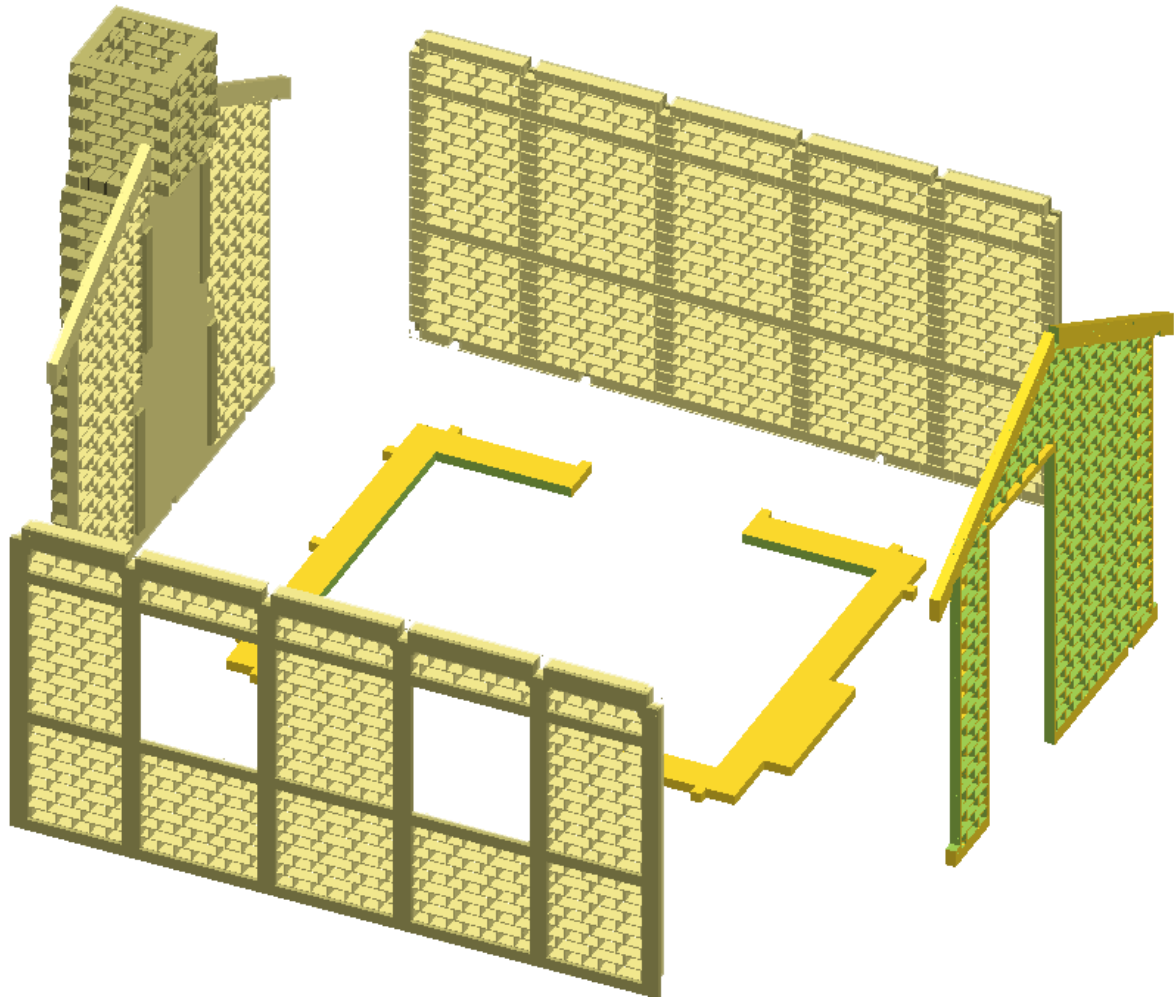

Once dry check the building corners. We deliberately make the wall overlays slightly too long as we have to allow for slight differences in the plywood thickness. If you find the overlays are protruding slightly; lightly file them back so they are flush. (We feel it is easier to file a little off rather than have to fill in little cracks).

Step 4 – End Overlays.

Now glue the end overlays on to the end walls and clean off any excess glue.

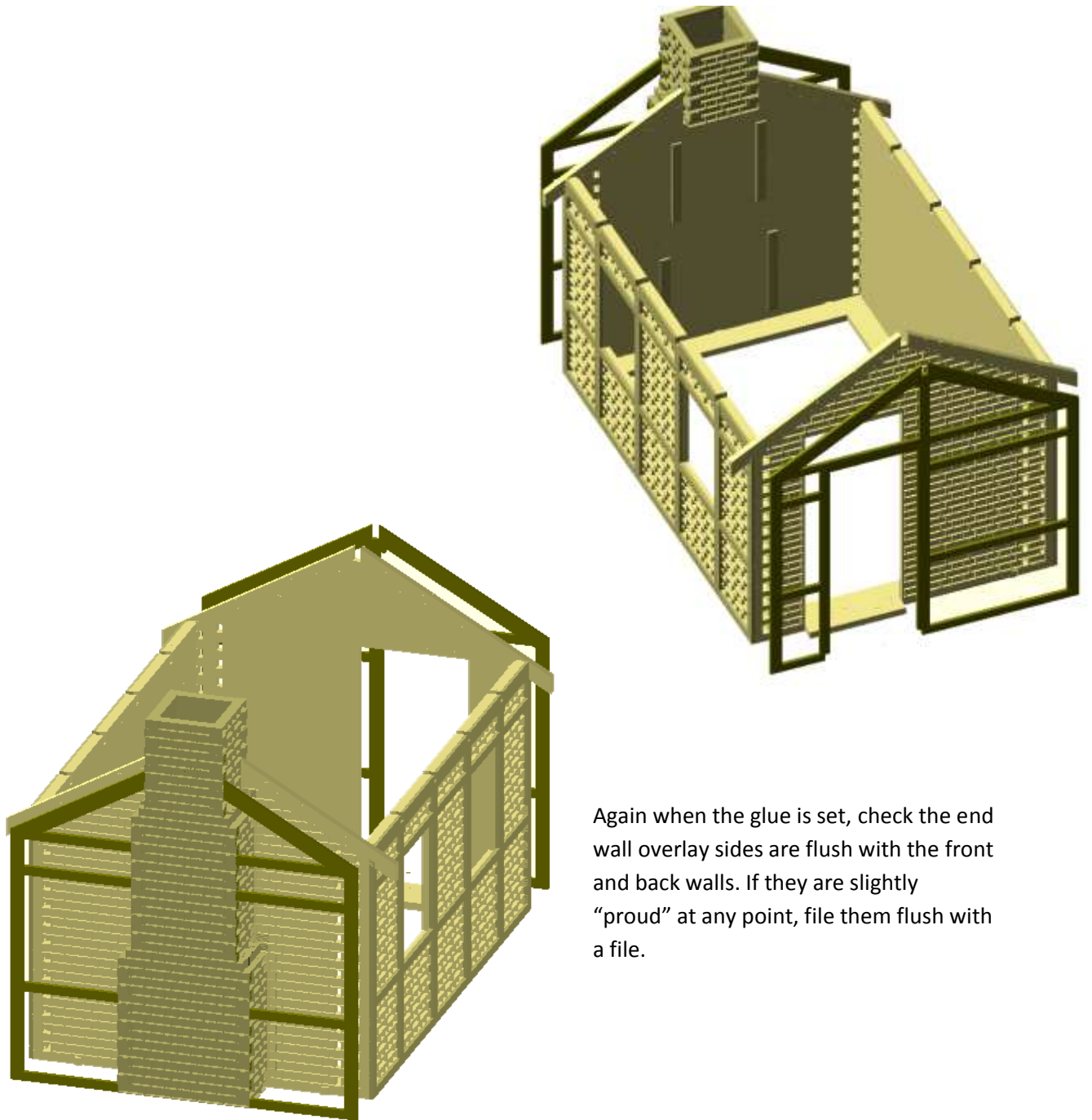

Again when the glue is set, check the end wall overlay sides are flush with the front and back walls. If they are slightly “proud” at any point, file them flush with a file.

Step 5 – Roof Assembly

Glue the 4 rafters into their sockets in the wall tops. (These sockets may need cleaning out with a file first if the overlays aren't aligned perfectly). Then glue the roof ridge beam in place. Allow glue to dry.

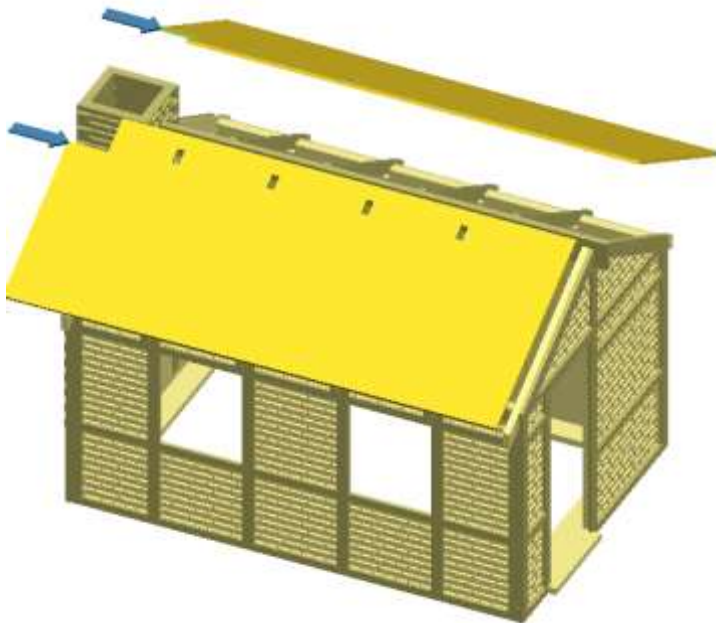
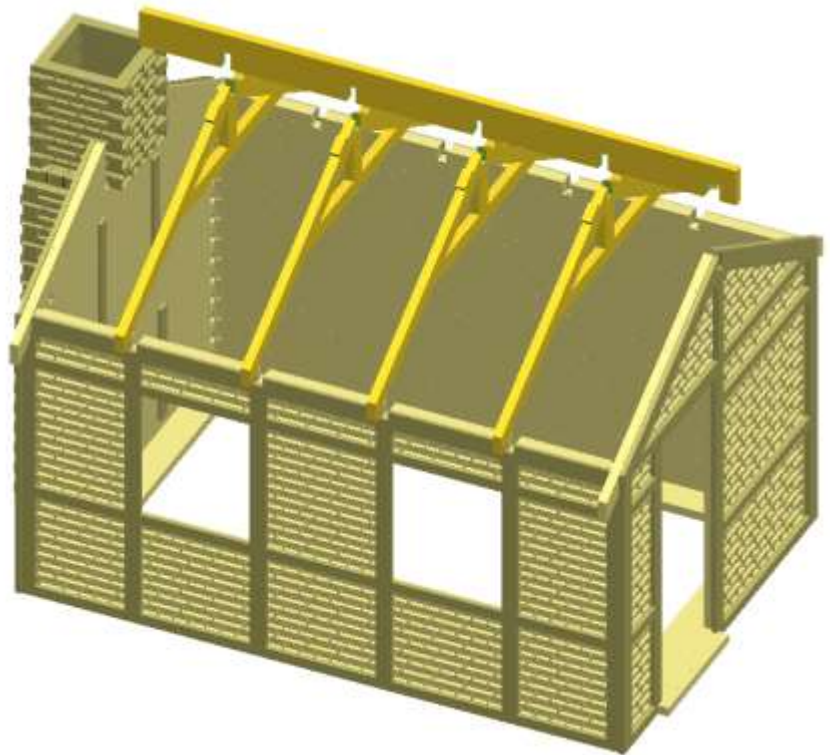

File a slight chamfer on edge of the chimney cut-outs in the roof panels (as indicated by the arrows) to match the roof angle. Then glue the roof panels in place onto the locating lugs on the rafters.

Glue the vacuum formed corrugated overlays to the 1.5mm ply wood roof panels; we suggest epoxy resin for this. Next cut the pre-formed roof ridge to size and glue onto the ridge

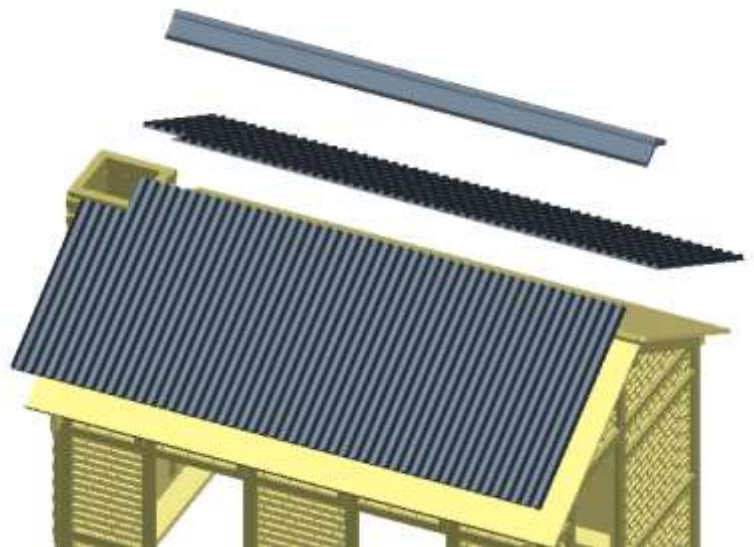

Step 6 – Windows and Door

We suggest you paint the window frames and door at this point.

The kit comes with a number of door signs. If you wish select one and glue to the door

Glue the 2 window frames to the glazing panes. We use a very thin bead of contact adhesive for this.

Now glue the window and door in place.

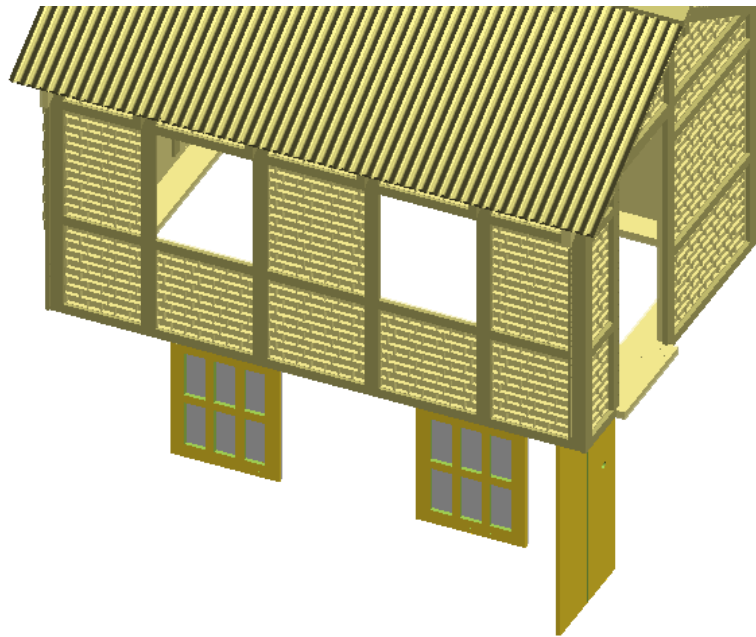

Step 7 – Chimney Pot

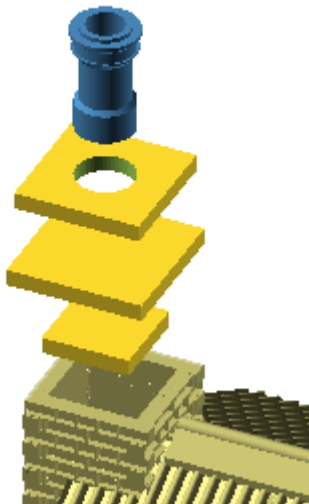

Glue the three parts of the chimney cap together and glue onto the chimney stack.

Finally glue the chimney pot in place.

Once glue is set; paint or varnish you model as you see fit.

JOB DONE !