

Carriage Shed Assembly Instructions

This kit is a freelance carriage shed based on photos of various prototypes. This building is modular in design, allowing further kits to be purchased to increase the buildings length. The building has no base so that you can easily lift the building to get to any rolling stock within the shed



Most of this kit is laser cut Poplar plywood. This is moderately water resistant but with a reasonably amount of painting or varnishing should prove rain resistant if not left outside all winter. We do however recommend using water proof PVA wood working glue (e.g., Evostick in the blue bottles) to glue the plywood parts together.

The roof overlays are vacuum formed HIPS. This is easily stuck with various glues and we suggest that epoxy resin (e.g., araldite) is used to stick them to the plywood roof panels.

Painting or varnishing is very much a matter of personal preference. We suggest you plan ahead and either paint the components before you assemble them or assemble the lot; paint in your base colour and then pick out the details in other colours. It's whatever works for you.

1 Side Panels

Glue the side panel planking (3mm plywood) to side panel framing (3mm plywood). Take care that the top and side edges are flush. Note the engraved planking detail should be on the outside.

Repeat for the other 5 panels.

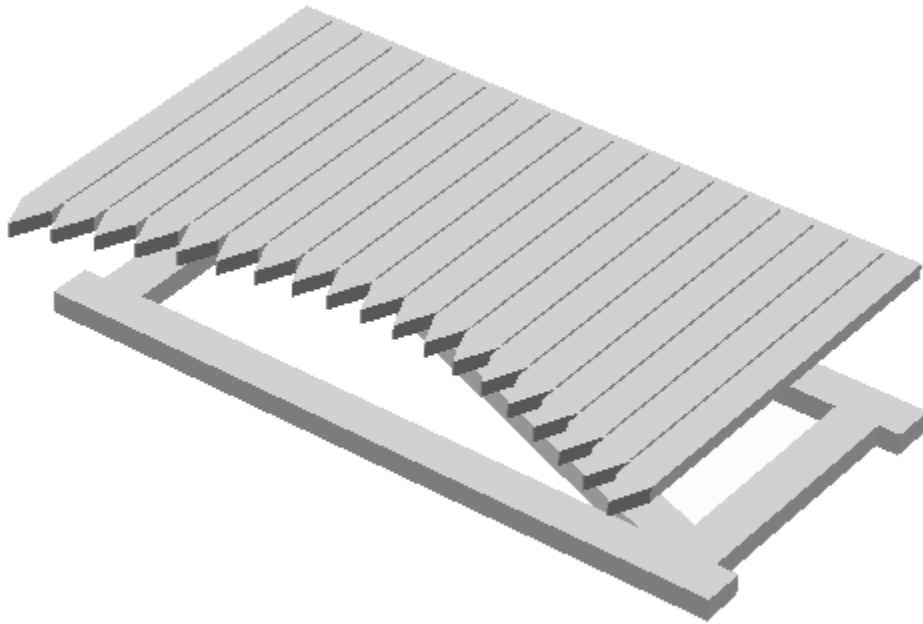

2 Main Structure

We suggest you do this on a nice flat surface like a sheet of glass.

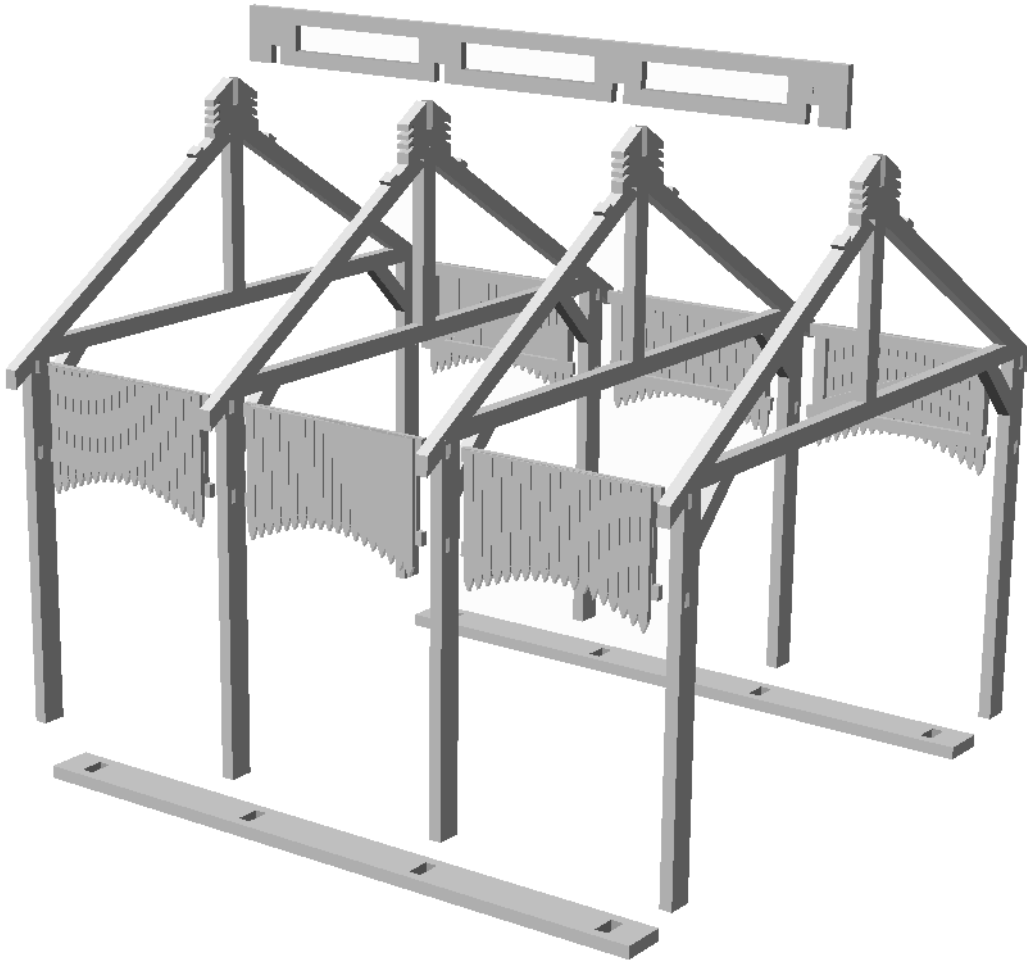

Glue the six side panels into their locating sockets in the four main “A frames” and the bottom of the “A frames” into the two base strips. This will help to keep the four frames in-line

Now glue the main roof ridge into the top of the “A frames”.

Note *If you plan to add an additional carriage shed module, the roof ridge and bases will need altering by cutting down the engraved line at one end*

Clamp up the assembly and set aside to dry.

3 Roof Panels

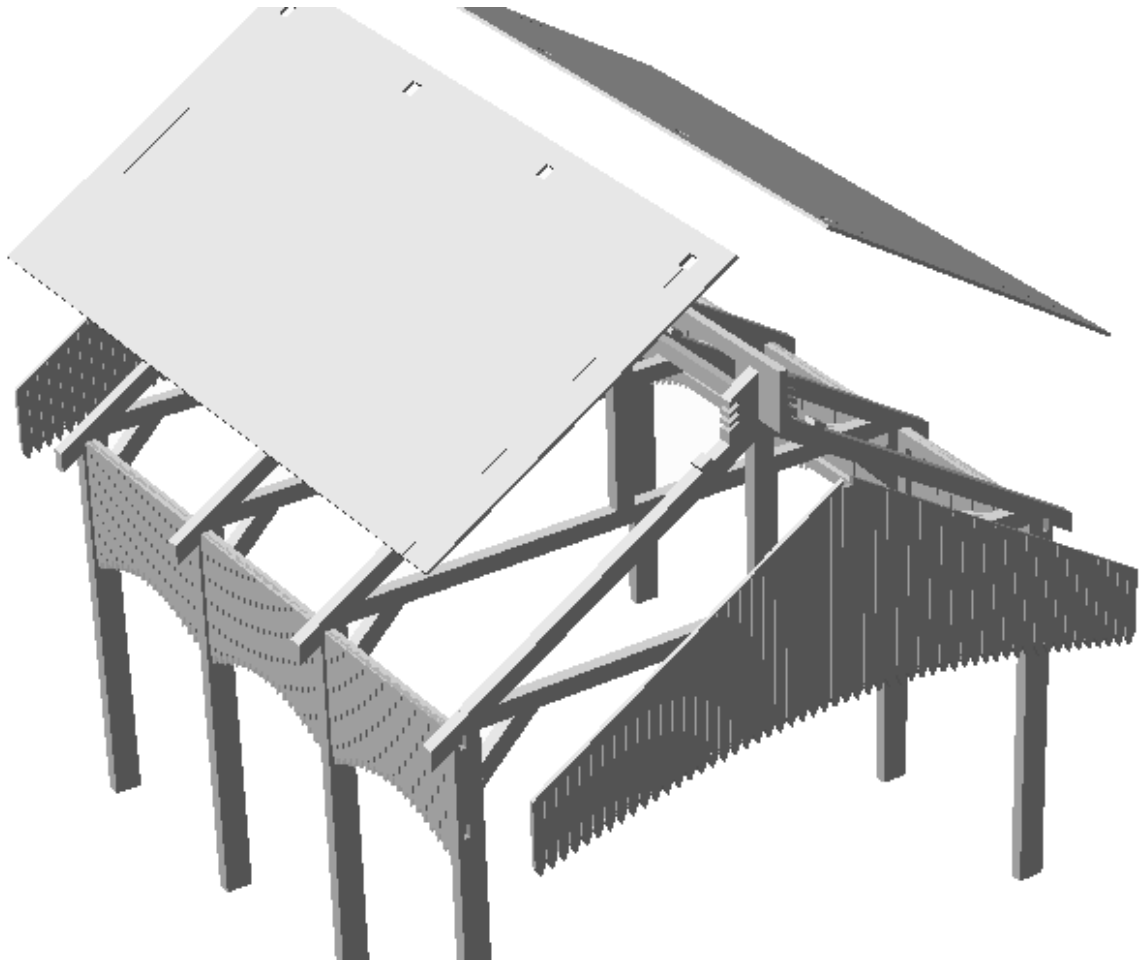

Glue the two roof panels (3mm plywood) onto the rafters.

Note *If you plan to add an additional carriage shed module, the roof panel will need cutting down the engraved line.*

Glue the rafter end overlays (3mm plywood) into place.

Note *If you plan to add an additional carriage shed module, then omit the overlay on the modified end.*

4 Smoke Stack

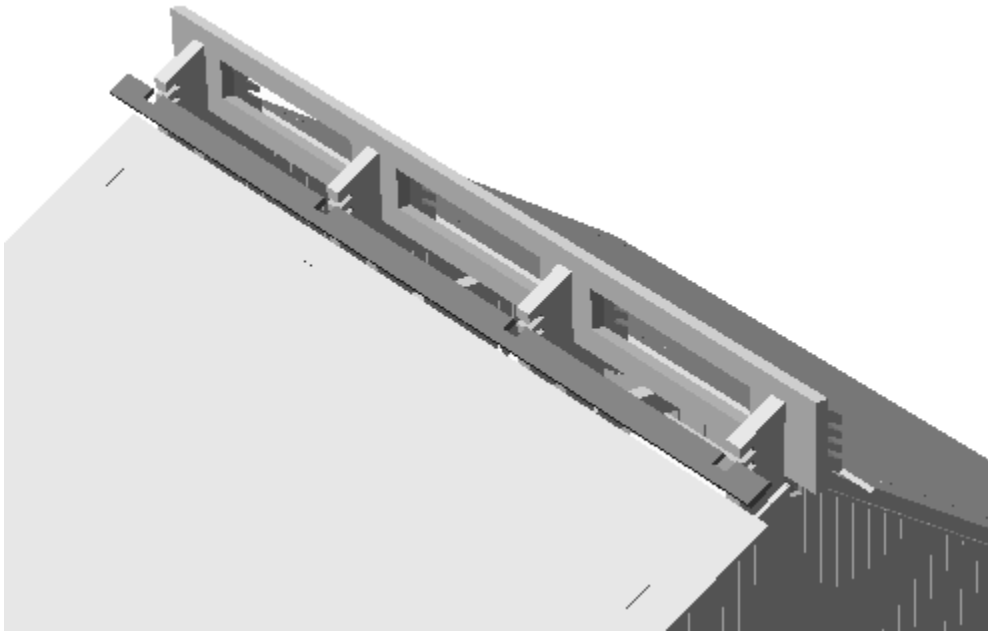

Detach the six smoke stack slats from the 1.5mm plywood fret. Glue the slats into their angled slots in the roof ridge.

Glue the two top slats in place.

Note *If you plan to add an additional carriage shed module, the slats will need cutting down their engraved lines.*

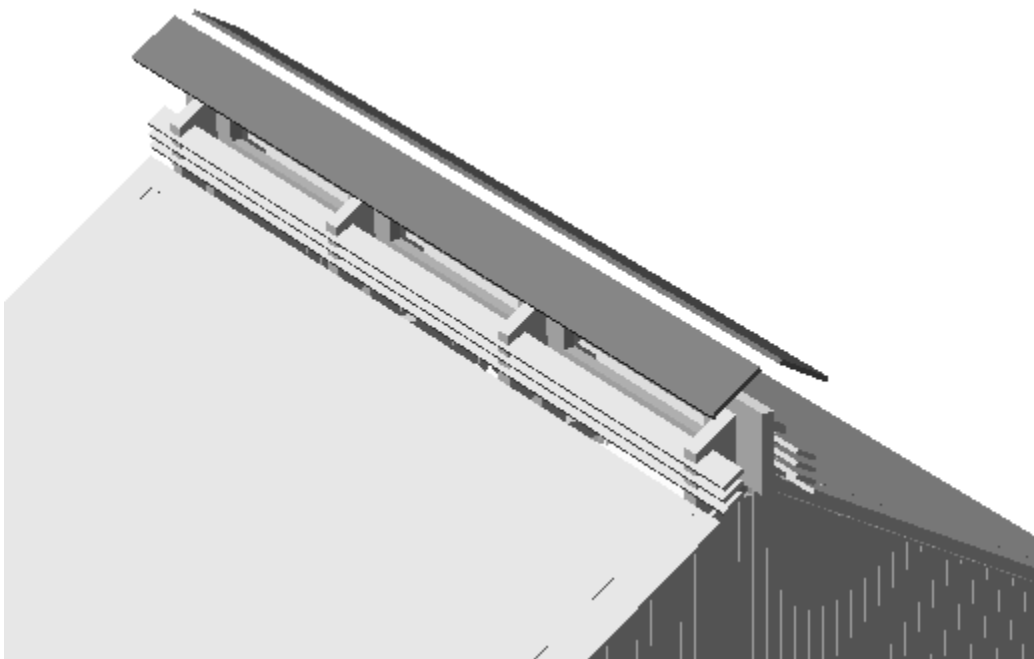

5 Corrugated Roofing

The kit is provided with a number of pre-cut corrugated plastic panels. The general idea is to glue them to the plywood roof panels overlapping each piece by a couple of ridges.

Glue the pre-cut corrugated roof panels in place. We suggest you use a gap filling adhesive like epoxy resin or the new Gorilla Glue “Kristal Clear” (not the original brown foaming stuff!).

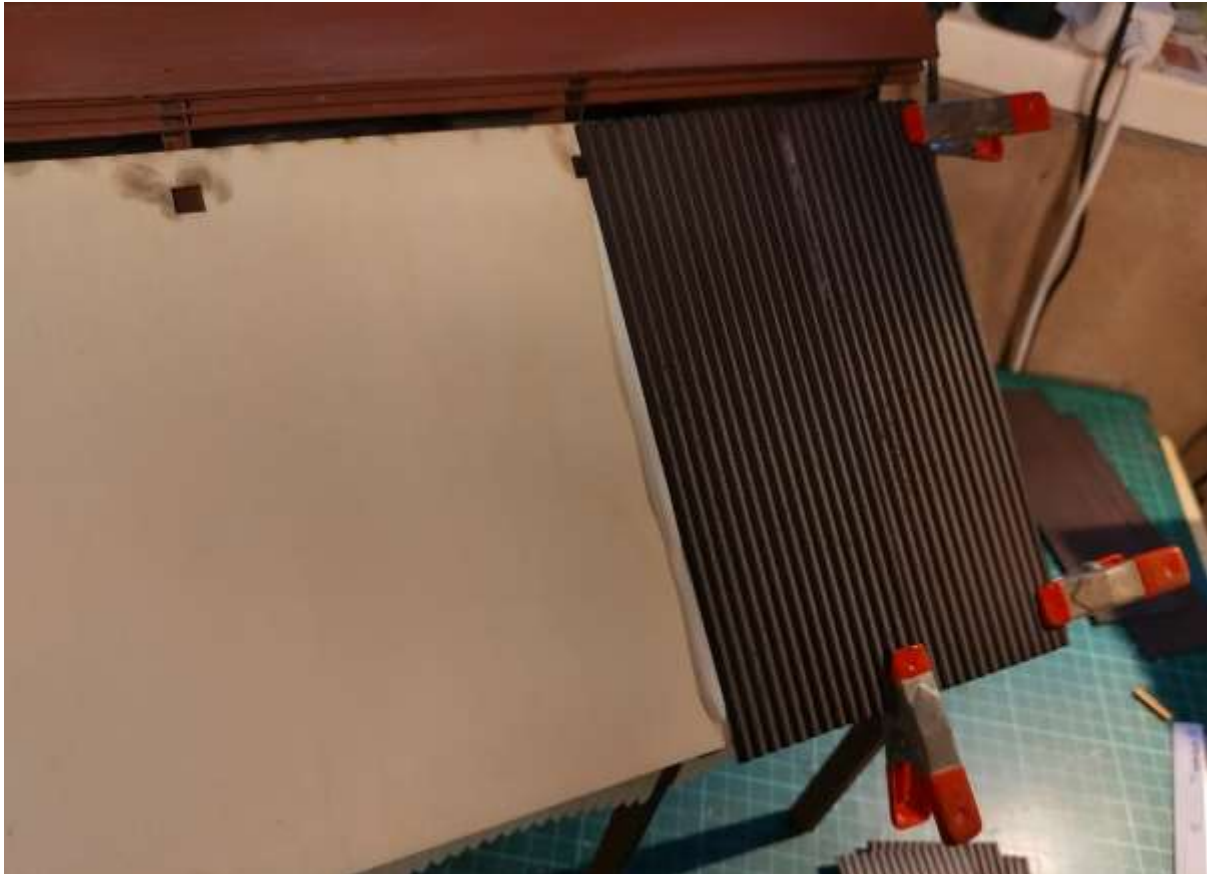

JOB DONE !

Parts List

Part	Material	Quantity	
A Frames	6mm ply	4	
Base strips	6mm ply	2	
Roof Ridge	4mm ply	1	
Side Panel Frames	3mm ply	6	
Side Panel Planking	3mm ply	6	
End Rafter Overlays	3mm ply	2	
Smoke Stack Fret	1.5mm ply	1	
Corrugated Roof Panels	1 mm HIPS	12	